



BULLIS charter school

A CALIFORNIA K – 8 PUBLIC SCHOOL

102 W. Portola Ave., Los Altos, CA 94022 • 1124 Covington Rd., Los Altos, CA 94024
Tel: 650-947-4100 • Fax: 650-947-4989 • www.BullisCharterSchool.com

March 25, 2016

Dear Los Altos School District Board of Directors,

April marks the 21st month since the signing of the 5-year settlement agreement. No doubt, both sides have benefited from the cessation of the resource-draining Proposition 39 process, enabling our organizations to focus on our most important function: providing a world-class education for our students. With just two months remaining in the school year, we are fast-approaching the half-way point of the Agreement, so we think it is a good time to check-in on the status of our mutual goal: to provide a long-term facility solution for Bullis Charter School. Since the Settlement Agreement was signed in July, 2014, BCS has worked hard to collaborate with the Los Altos School District in a positive spirit, achieving important milestones for our community. First, in November 2014 Measure N was passed with strong support from the BCS Community, providing the District with the means to provide a true long-term facilities solution for all local public school students. In the meantime, BCS and LASD worked in partnership to enhance the temporary split-campus BCS site by installing nine portables across the Egan and Blach sites. BCS adhered to the Agreement's total student enrollment cap (required by the District as part of the Settlement) of 775 students for the 2015/16 school year.

No longer a startup, BCS is a thirteen-year old, nationally recognized institution drawing families to Los Altos who seek an alternative public school option. Working collaboratively is more important than ever because BCS is now educating a full 15% of Los Altos public school students and demand for the BCS model is greater than ever before. For every kindergarten student admitted to BCS through the State mandated random lottery, BCS must unfortunately turn away three students due to lack of space. In a world where traditional public school districts everywhere are facing increasing pressure to innovate, personalize and respond to student needs and policy shifts, the ability of BCS and the LASD to coexist in a mutually beneficial partnership might serve as a national model for innovation-sharing across diverse public school programmatic structures. We welcome discussing opportunities to share best practices with each other and thereby improve the educational experience of all local public school students.





BULLIS charter school
A CALIFORNIA K – 8 PUBLIC SCHOOL

102 W. Portola Ave., Los Altos, CA 94022 • 1124 Covington Rd., Los Altos, CA 94024

Tel: 650-947-4100 • Fax: 650-947-4989 • www.BullisCharterSchool.com

As you can imagine, the long-term facility plan for BCS is a top priority for our school community. We're eager to move forward with you to find a permanent site and will act to support your process as efficiently and productively as possible. I hope you share our sense of urgency. We appreciate the district's foresight in commissioning the Gelfand Report in 2014, and we believe that the report (attached for easy reference) captures the essential elements needed in a BCS site. We would welcome the opportunity to have a full seat at the table to discuss these and other ideas while working to ensure we all are listening to the community needs as well. We propose reactivating the Facilities Master Planning Process with BCS, LASD and other community members involved as soon as possible.

If you sense that a long-term solution is out of reach for whatever reason, we would like to understand those dynamics sooner rather than later, because it will almost certainly impact our plans for school growth and enrollment following the expiration of the Agreement. We intend to be full partners with LASD and the larger community and to act in the best interests of all our collective public school students.

Sincerely,

John Phelps
BCS Board Chair on behalf of the BCS Board

Attachment: Gelfand Partners Drawings from Oct 2014



**School Program for 900 student K-8
classroom loading at 20/class K-3, 25/class 4-8**

	Size (sf)	Number	Total SF
Kindergarten	1350	5	6750
Grades 1-3	960	15	14400
Grades 4-5	1080	8	8640
Grades 6-8	960	12	11520
Flex and STEM rooms	1200	4	4800
RSP	960	1	960
Science	1200	1	1200
Art	1200	1	1200
Multi			
assembly space @ 900*7	6300	1	6300
servery	480	1	480
stage	700	1	700
storage	300	1	300
PTA work/storage	250	1	250
music/drama	1200	1	1200
locker rooms	1200	1	1200
Library			
reading room	2500	1	2500
story space	500	1	500
project room	500	1	500
media studio	250	1	250
office	150	1	150
IT	150	1	150
grade 1-2 computer lab	480	1	480
Small group instruction, ESL, Speech	250	9	2250
Admin			
reception	700	1	700
principal office	200	1	200
assistant principal office	200	1	200
psych/counseling	180	3	540
conference room	250	1	250
health and restroom	275	1	275
staff work	840	1	840
staff lounge	960	1	960
Restrooms/support			
adult restrooms	50	8	400
student restrooms	360	6	2160
student restrooms	180	2	360
janitor	360	1	360
interior corridors, stairs			10522

note: storage, prep, restrooms included in kindergarten, flex, science, art



K-8 School 900_Proposed_14 acrs

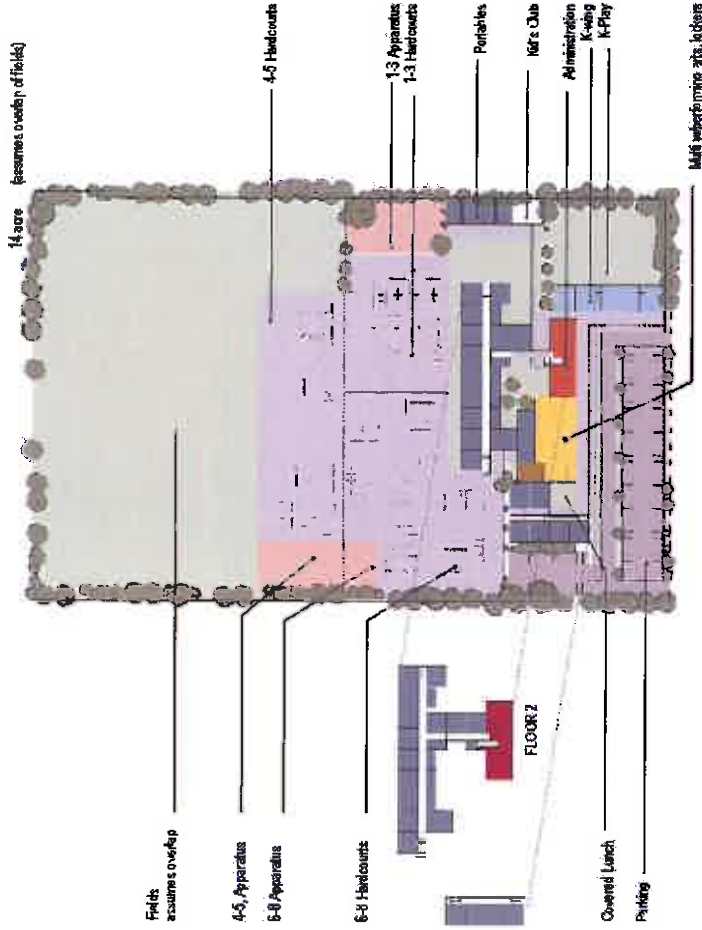

- Multipurpose
- Administration
- Library
- Classroom
- Flex Space
- Computer
- Science
- Performing Arts
- Gym
- Lockers
- Kindergarten



K-8 School 9001_Proposed_11 acre

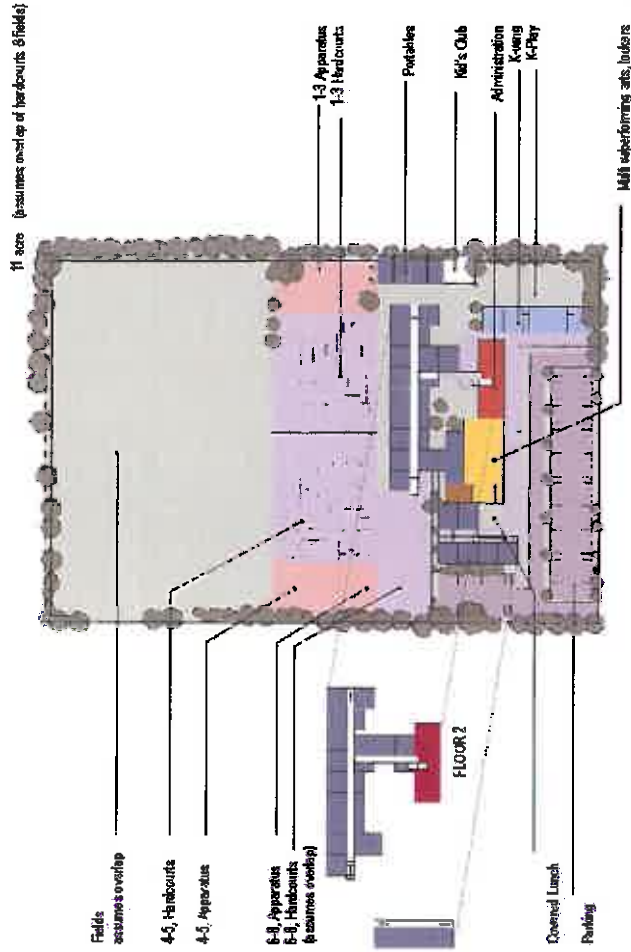

- Multi-purpose
- Administration
- Library
- Classroom
- Flex Space
- Computer
- Science
- Performing Arts
- Gym
- Lockers
- Kindergarten